

the GRAND BALLROOM STAGE

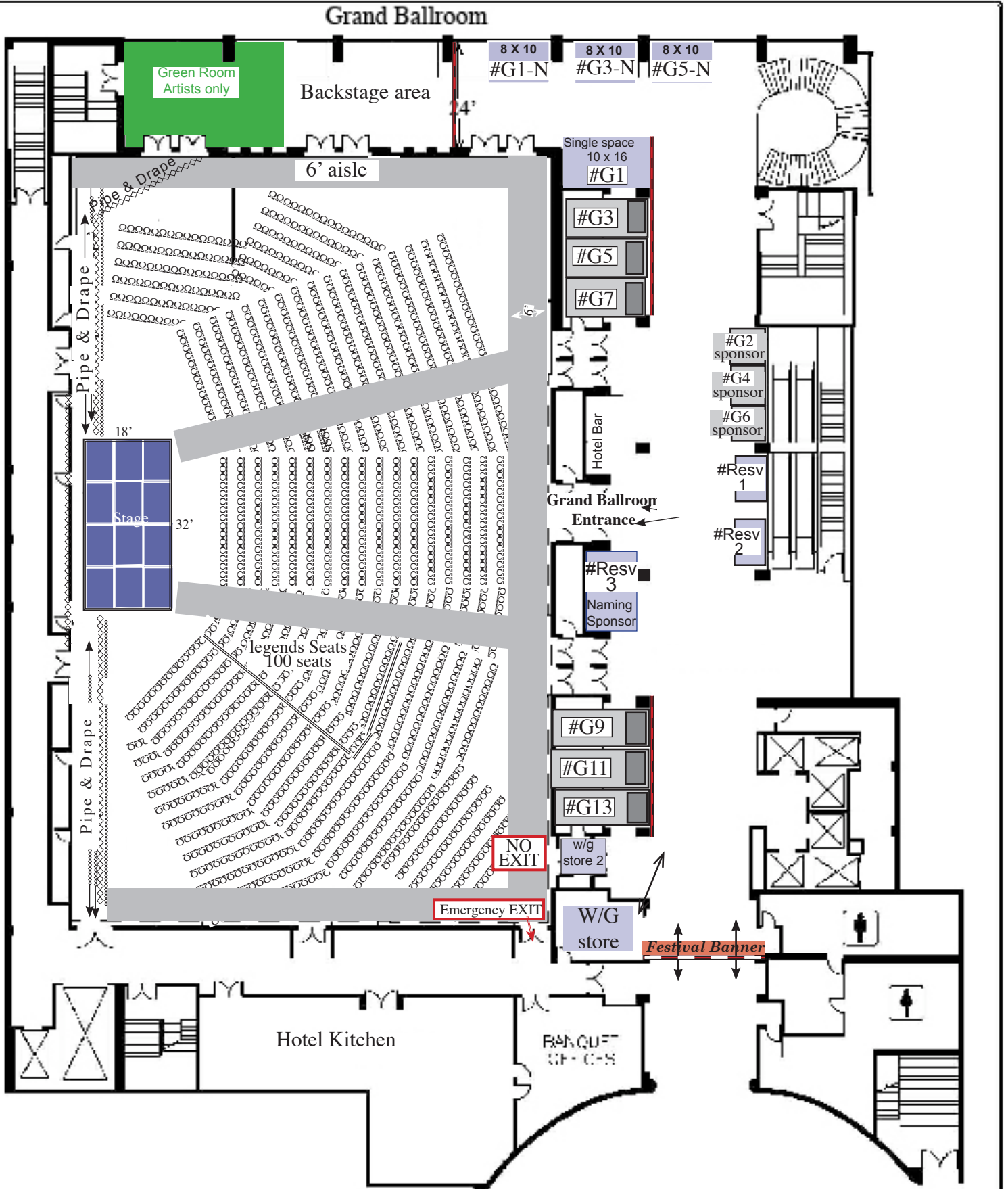

Spruce Room

The Spruce Room is down the hall from the Grand Ballroom and across from the Festival Registration area. This mainly Instrument related products room is great for showing your Instruments and being with other builders and Instrument related Vendors. This Room will also serve as a workshop area all during the Festival.

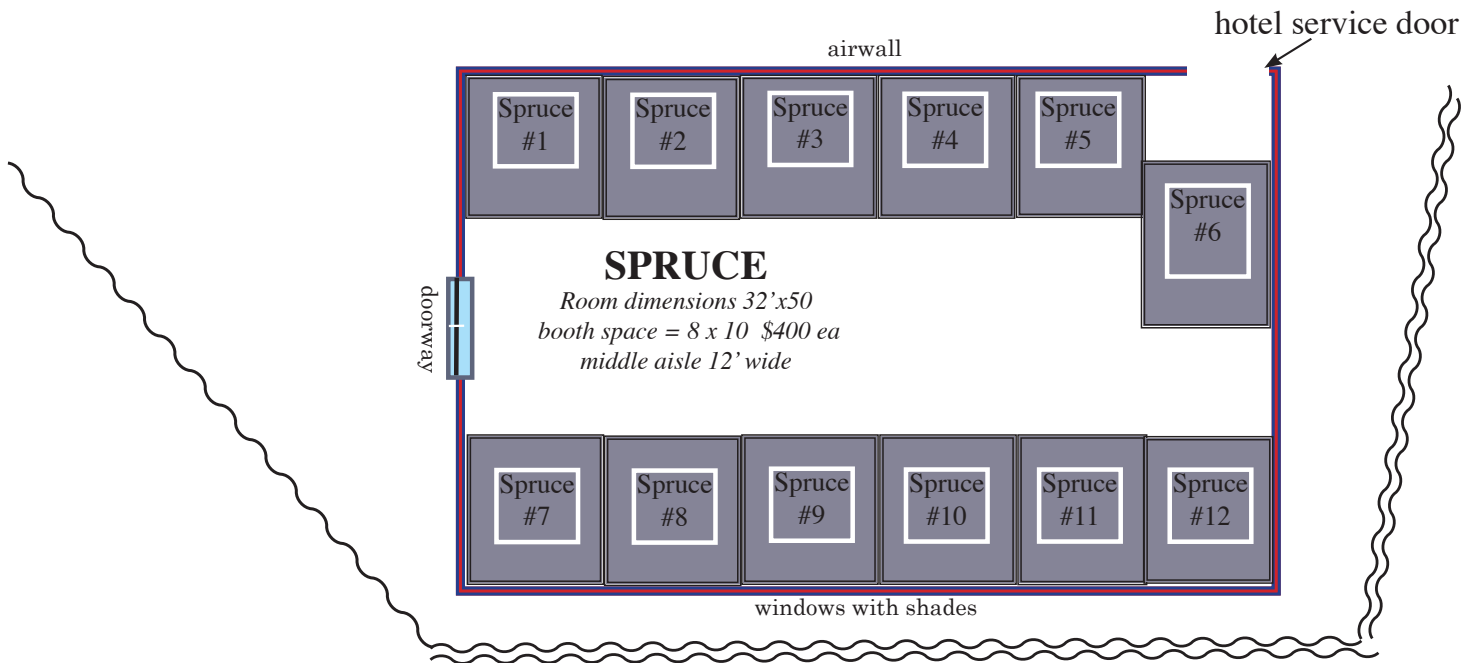

WINTERGRASS VENDOR SPACE COST *(see maps and Wintergrass Application for space specifics)*

SPRUCE ROOM *Instrument Mercantile* (1 or 2 -30"x60" tables available) 8 'x 10' space **\$ 400ea**

EVERGREEN BALLROOM LEVEL *(Performance and Dance Stage)*

Evergreen Rooms A & B (9 spaces ea) 8 'x 10' space = \$ 500ea

LOBBY AREAS (Evergreen Prefunction areas Non Lockable spaces)

E1, E3a, E3, E5, E7, E9, E11 = \$ 600ea

E13 *Lockable private room* = \$ 1000

NE2, NE4, NE6, NE8, NE10 *app 8 x 10* = \$ 400ea

GRAND BALLROOM LEVEL

LOBBY AREAS (outside Grand Ballroom, Non Lockable spaces)

G1 10 x 16 = \$800

G3, G5, G7, G9, G11, G13, 8 x 12 = \$500

G1-N, G3-N, G5-N 8 x 10 = \$400

G2, G4, G6 *(Sponsors)* 8 x 10 = \$400

Resv 1 *Wintergrass reserved area*

Resv 2, *Sponsor space* 8 x 10 = \$600

Resv 3 *Naming Sponsor space* 10 x 16 = \$1000

Please see Wintergrass Vendor Application for all space and Vendor Costs.
 Questions please email Ross Gililand at Vendors@Wintergrass.com